

PB 7-4

SCALE 1" = 100'

**Q CURVE DATA**  
 P.I. STA. 814+55.33  
 $\Delta = 20^\circ 11' 55''$  LT.  
 R = 1435.98'  
 D =  $03^\circ 59' 24''$   
 T = 255.77'  
 L = 506.23'  
 P.C. STA. 811+99.56  
 P.T. STA. 817+05.79

**Q CURVE DATA**  
 P.I. STA. 824+31.55  
 $\Delta = 20^\circ 11' 45''$  RT.  
 R = 1506.28'  
 D =  $03^\circ 48' 14''$   
 T = 268.25'  
 L = 530.94'  
 P.C. STA. 821+63.30  
 P.T. STA. 826+94.24

**END PROJECT**  
 Q STA. 826+94.24

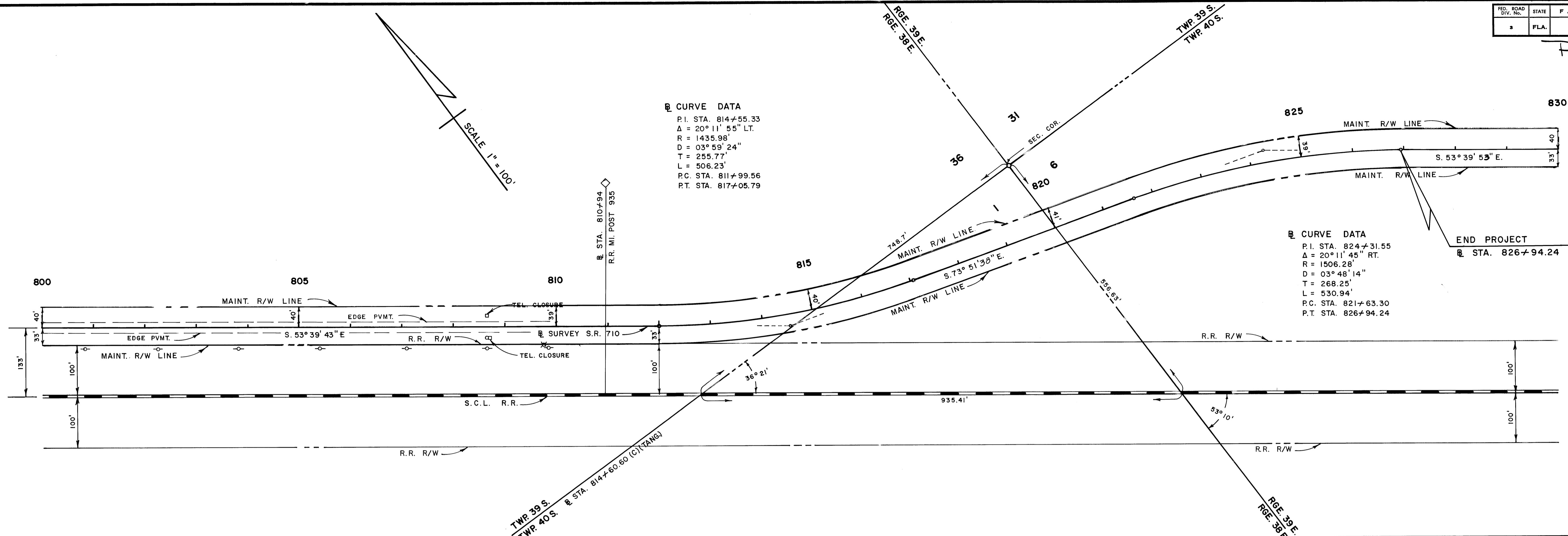

STATE OF FLORIDA DEPARTMENT OF TRANSPORTATION			
<b>MAINTENANCE MAP</b>			
STATE ROAD NO. 710		MARTIN COUNTY	
BY	DATE	APPROVED BY	DATE
DRAWN STOUT	MAY 76	<i>William E. Smith</i>	
TRACED STOUT	JUL. 76		
CHECKED		<i>D. E. Skidell</i>	8-10-76
COMPARED			
INDEXED			
REVISION		BY	DATE
SECTION 89070-2515		SHEET 10 OF 10	